

EDIFICIO A

SCHEDA TIPOLOGIA D

SCHEMA TIPOLOGIE
PIANO 1°-2°-3°

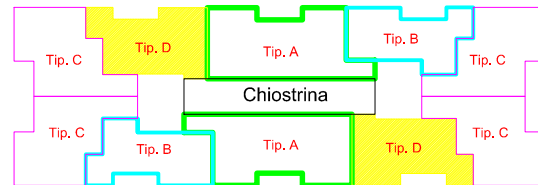

APPARTAMENTI
TOT. 2x3=6

PIANO 1°-2°-3°

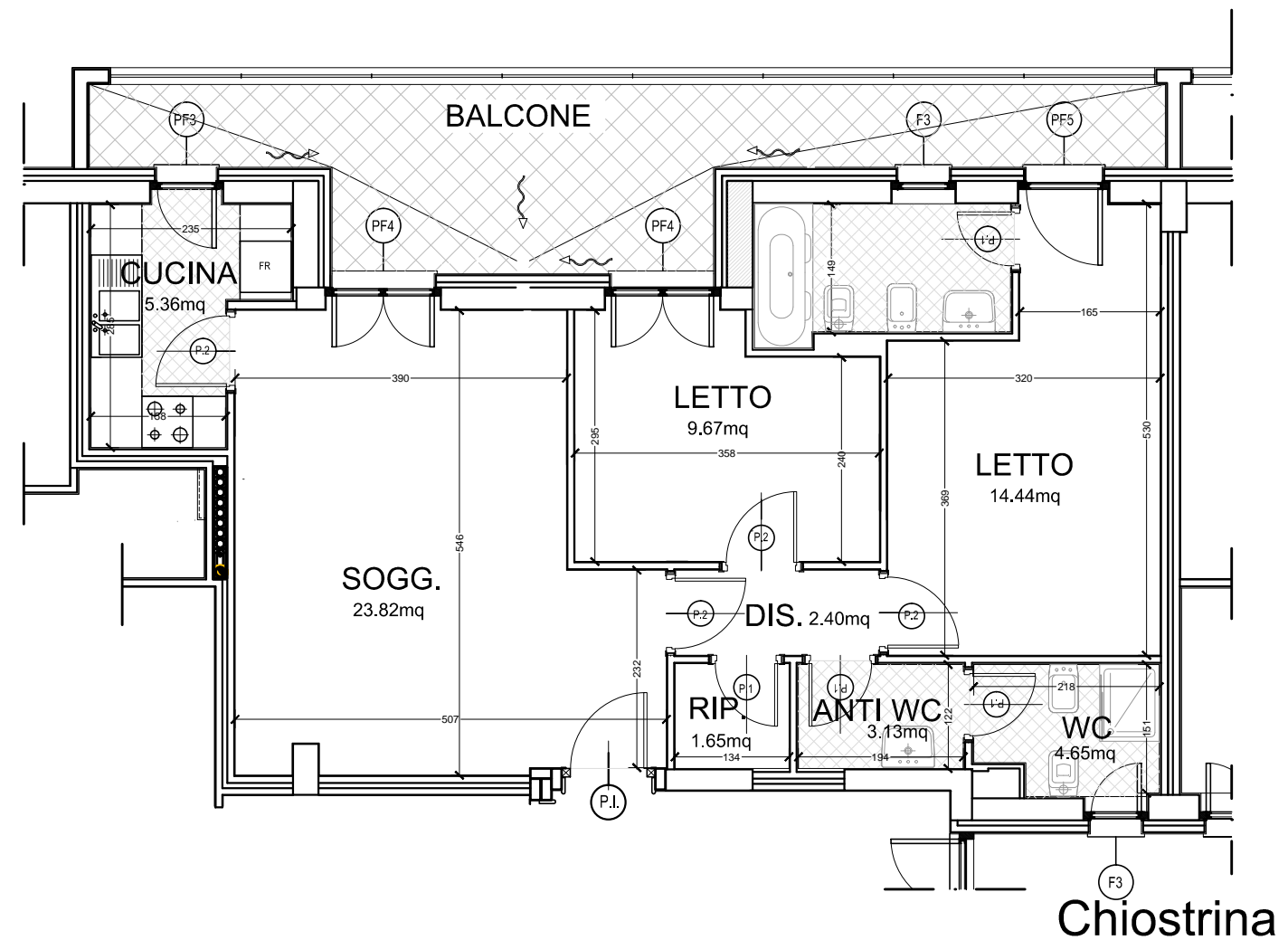

Tipologia D (N.6)

SUL 79,72

SU 67,49

SNR 17,88

SP 12,35

SC 89,67

CALCOLO SC

(Sup. Commerciale):

S.C. = SUL+SPR (sup. pertinenze rag.)
 Ai sensi del B.I.R. si avranno:
 SU+murature=SUL 100%
 Balconi/Loggie 35%
 Terrazzi/Lastrici 25%
 Soffitte 20%
 Posti Auto 30%